

5 SINGLE UNIT - OPTION 5
1/4" = 1'-0"

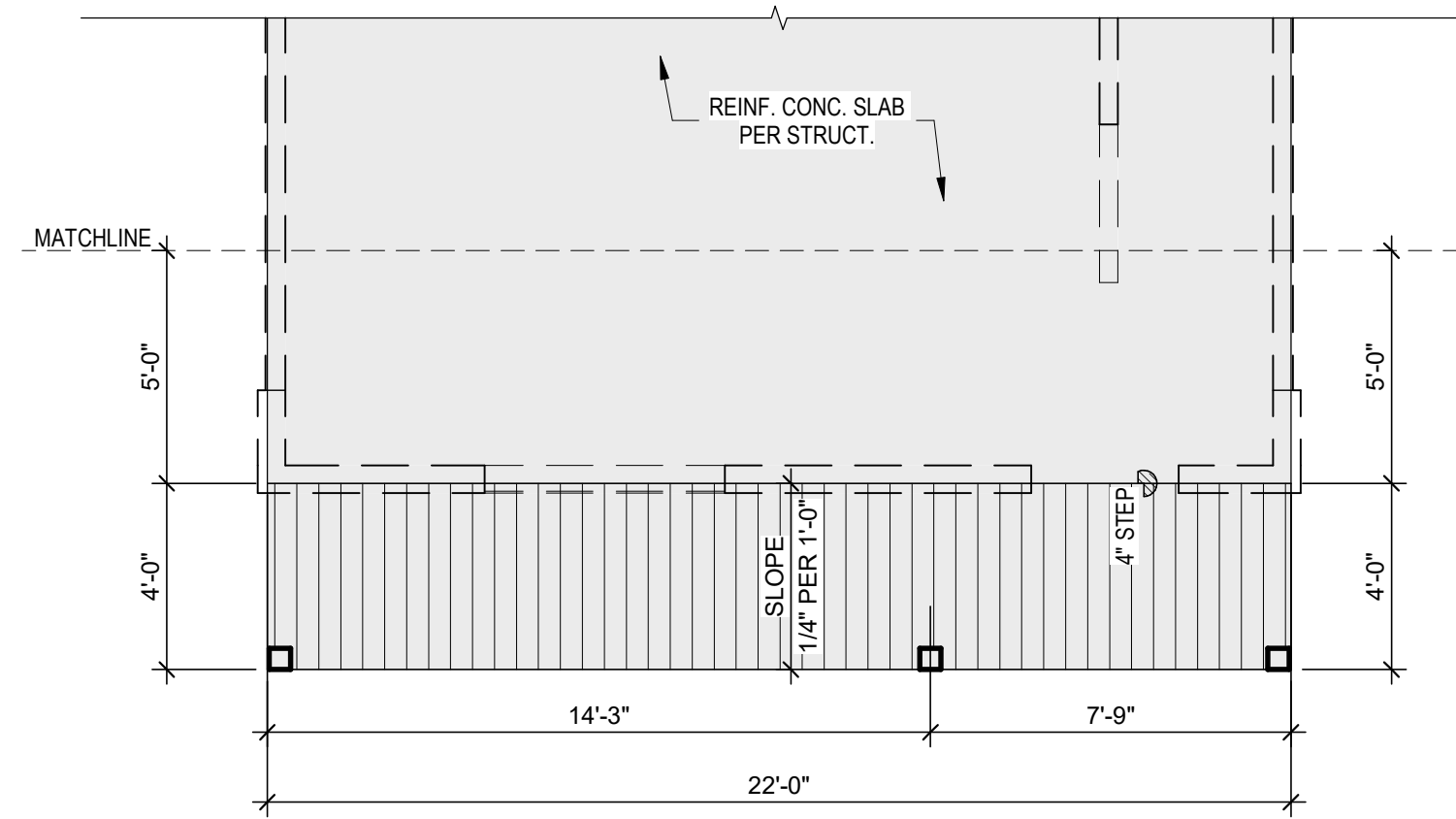

4 SINGLE UNIT - OPTION 4
1/4" = 1'-0"

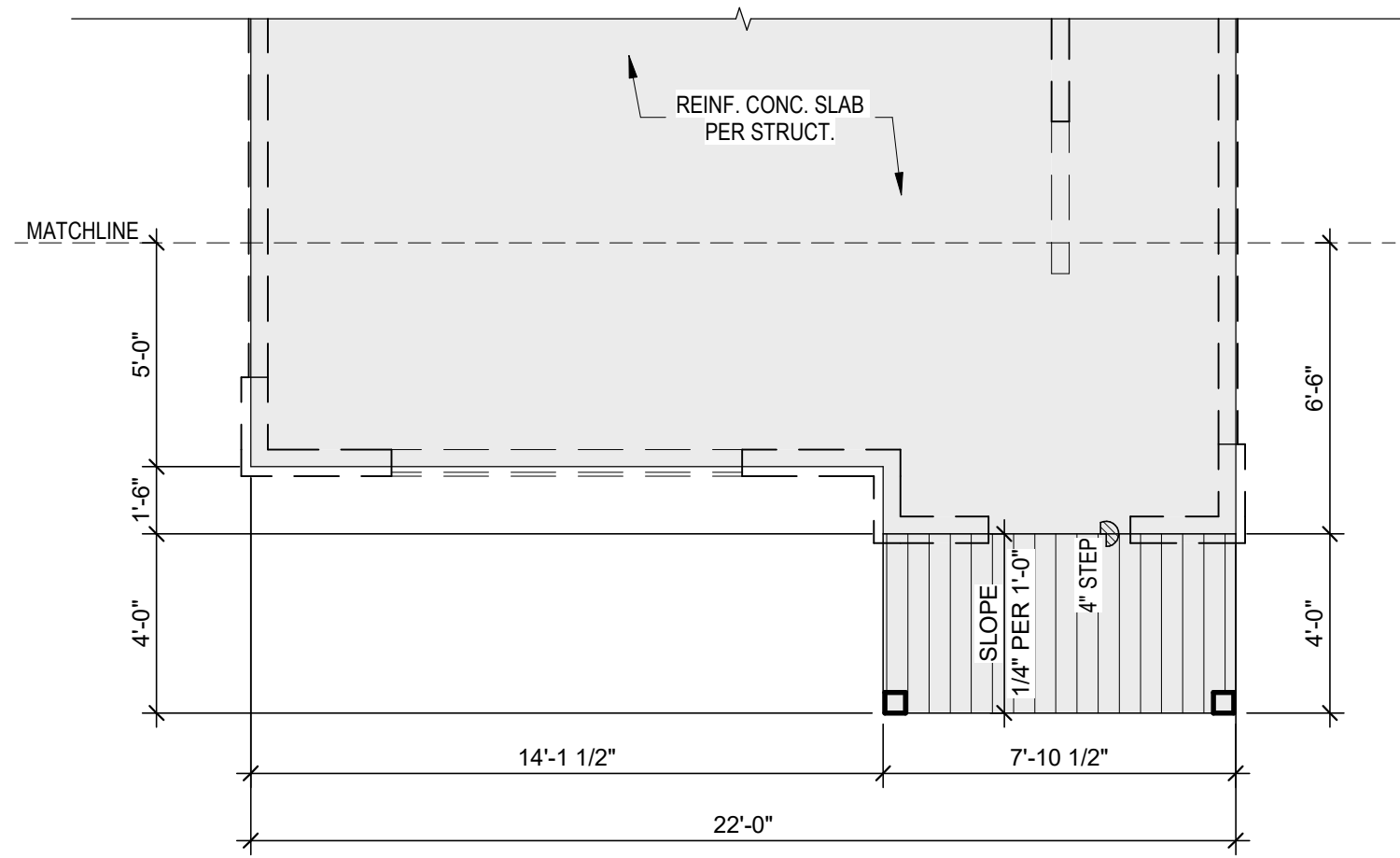

3 SINGLE UNIT - OPTION 3
1/4" = 1'-0"

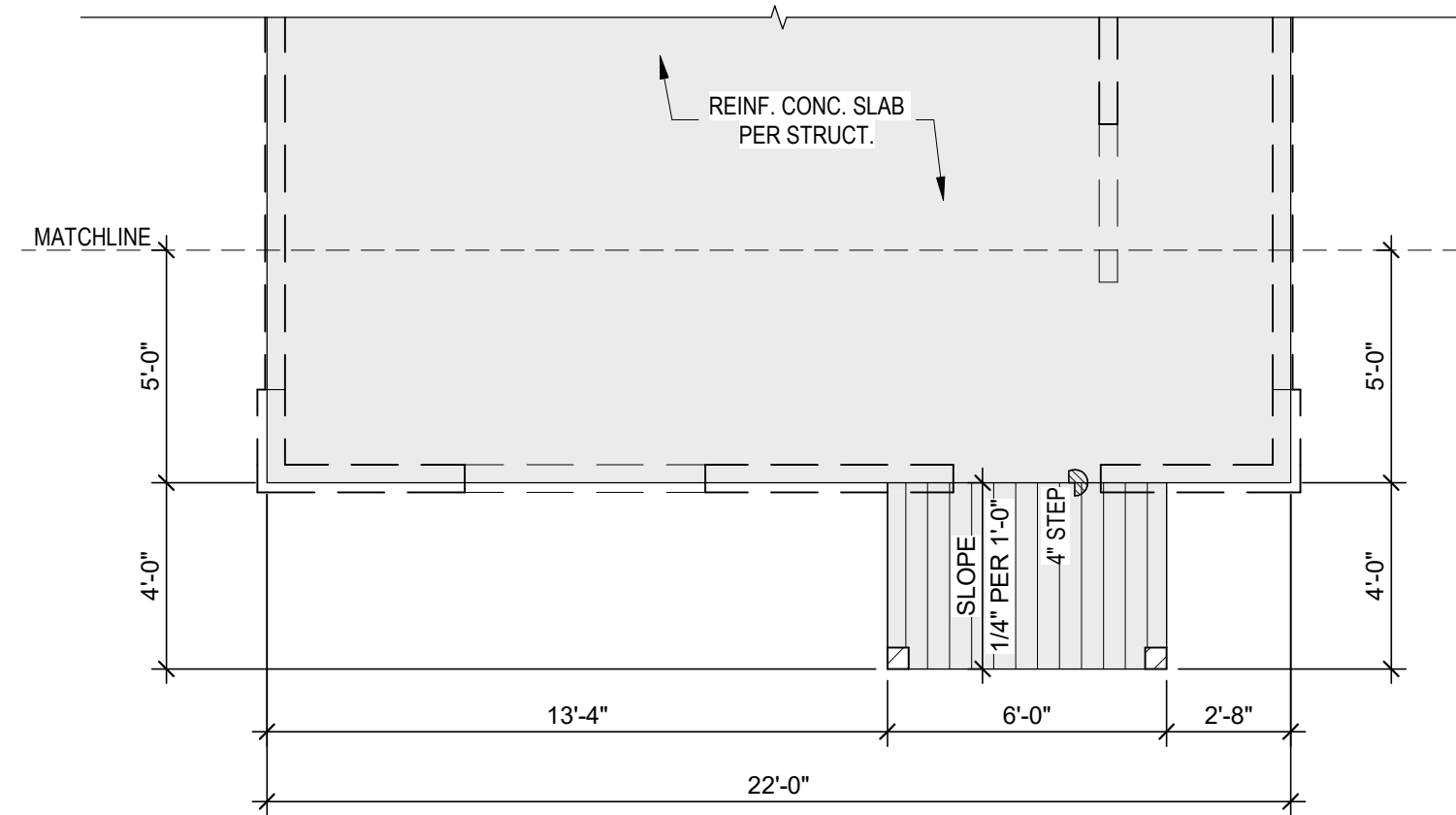

2 SINGLE UNIT - OPTION 2
1/4" = 1'-0"

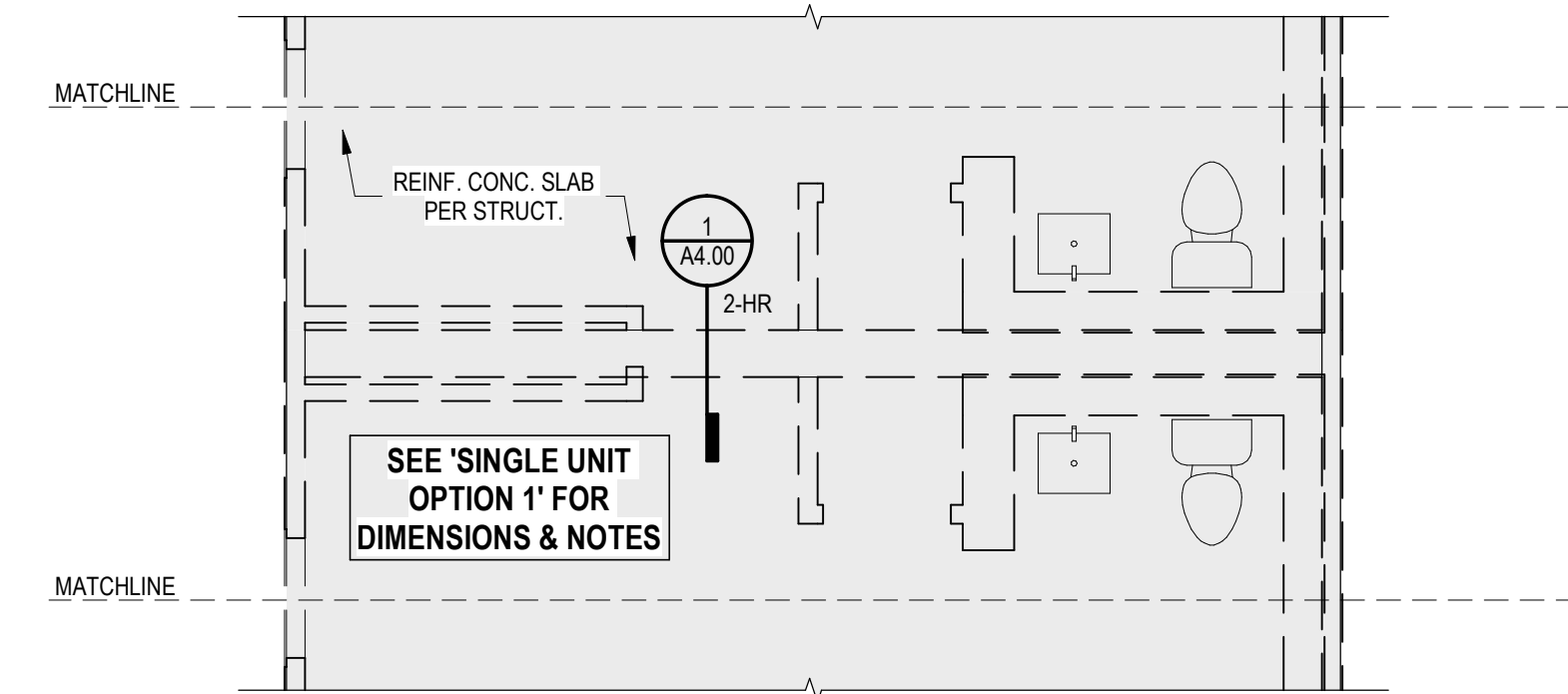

6 SINGLE UNIT CONDITION at DEMISING WALL
1/4" = 1'-0"

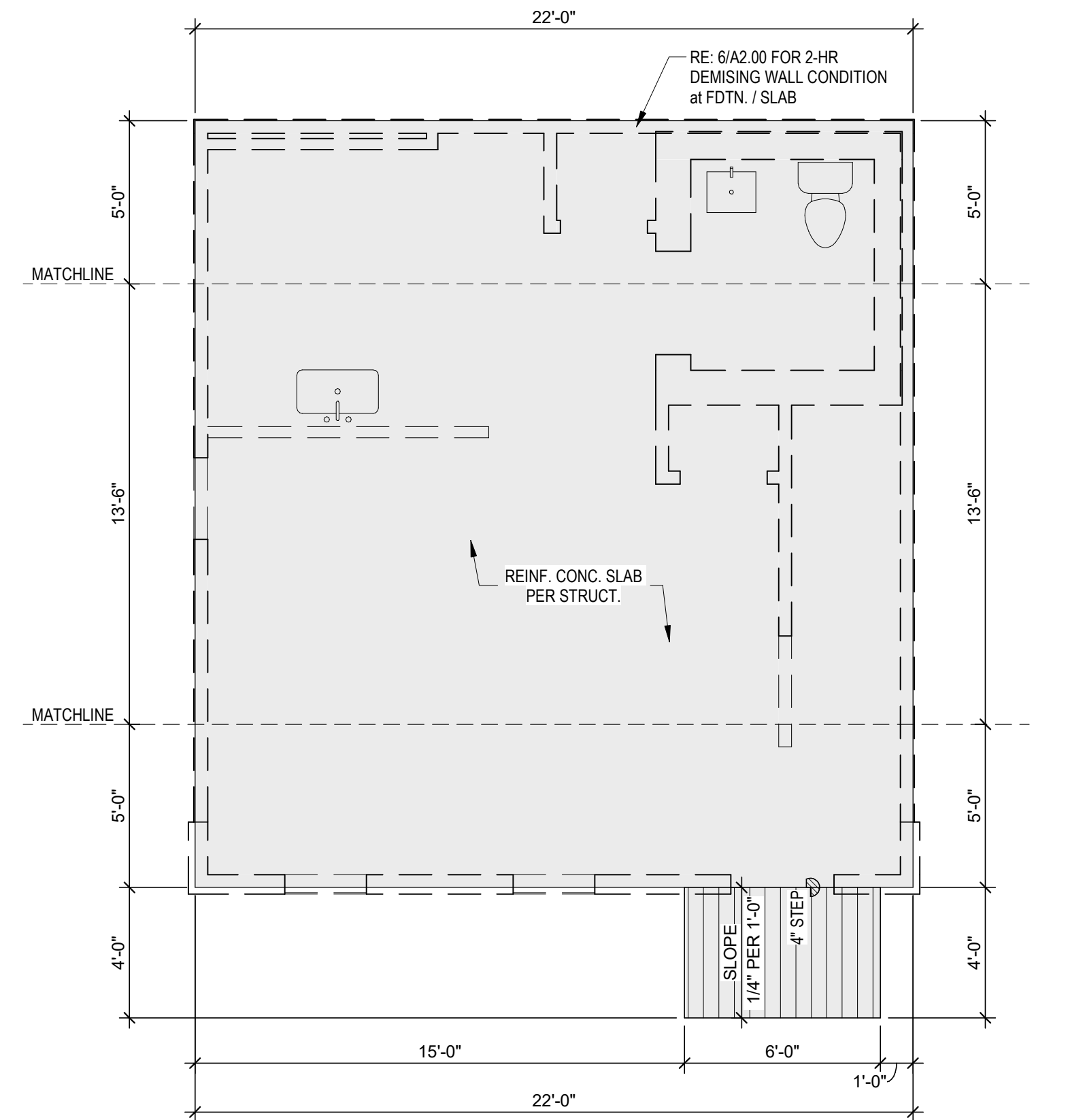

1 SINGLE UNIT - OPTION 1
1/4" = 1'-0"

