

6 FEMA SAFE ROOM PLAN
1/4" = 1'-0"

TOTAL USABLE FLOOR AREA	TOTAL OCCUPANTS
35.95 SF	35.95 SF / 3 SF* = 11.9 OCCUPANTS

*MINIMUM USABLE FLOOR AREA IN SF PER SAFE ROOM OCCUPANT IN ACCORDANCE WITH TABLE B5-3 IN THE FEMA P-361

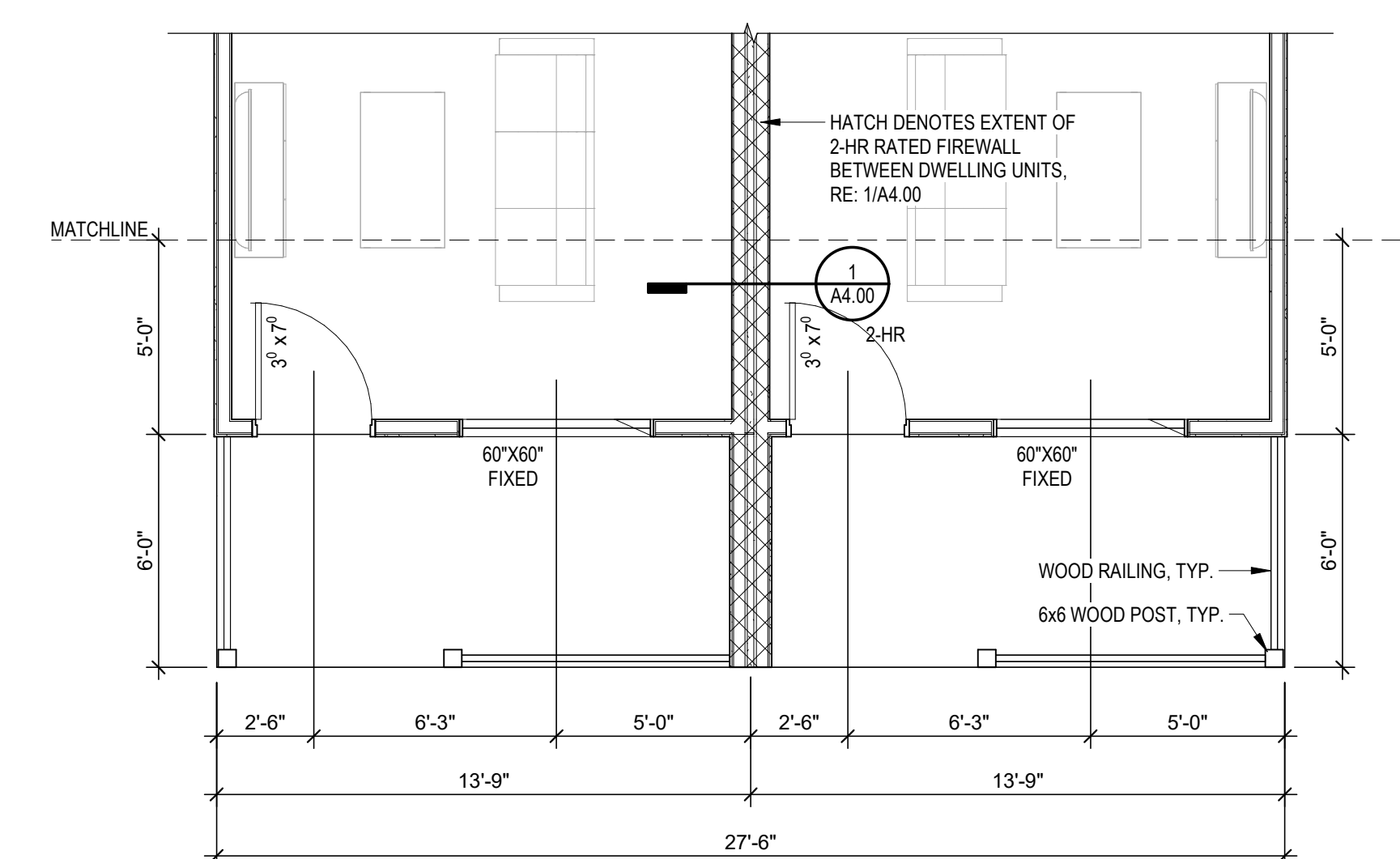

5 DOUBLE UNIT - OPTION 5
1/4" = 1'-0"

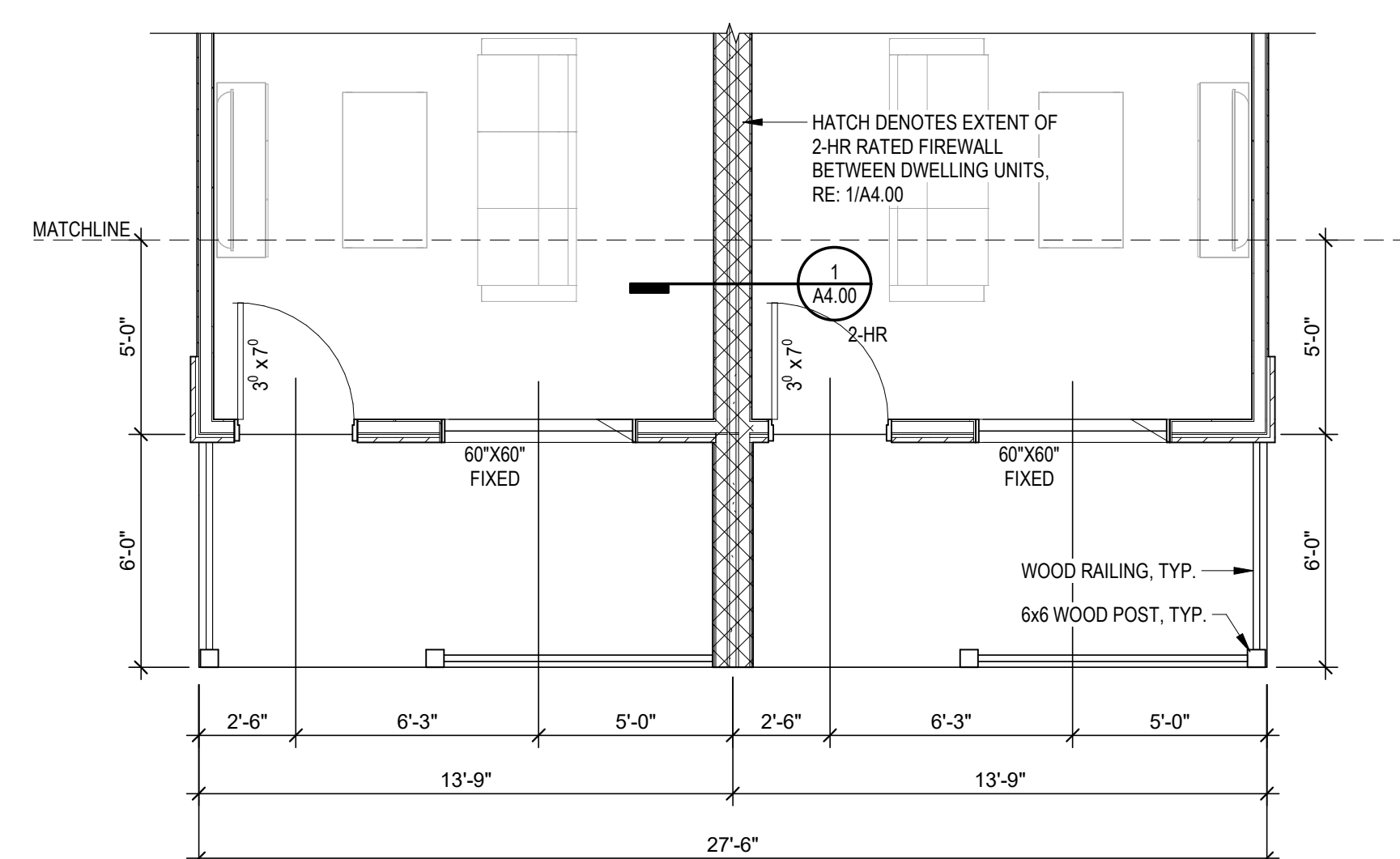

4 DOUBLE UNIT - OPTION 4
1/4" = 1'-0"

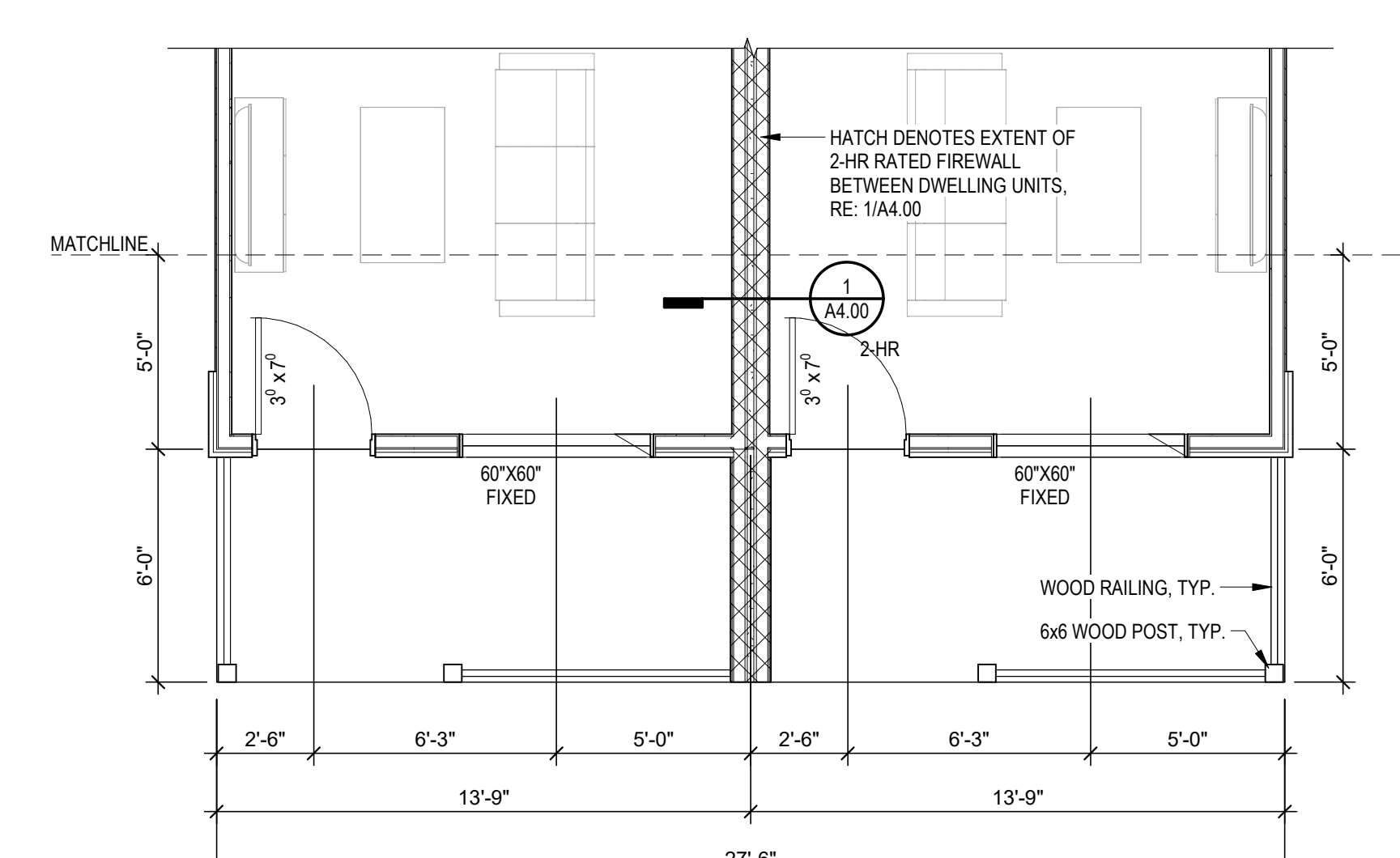

3 DOUBLE UNIT - OPTION 3
1/4" = 1'-0"

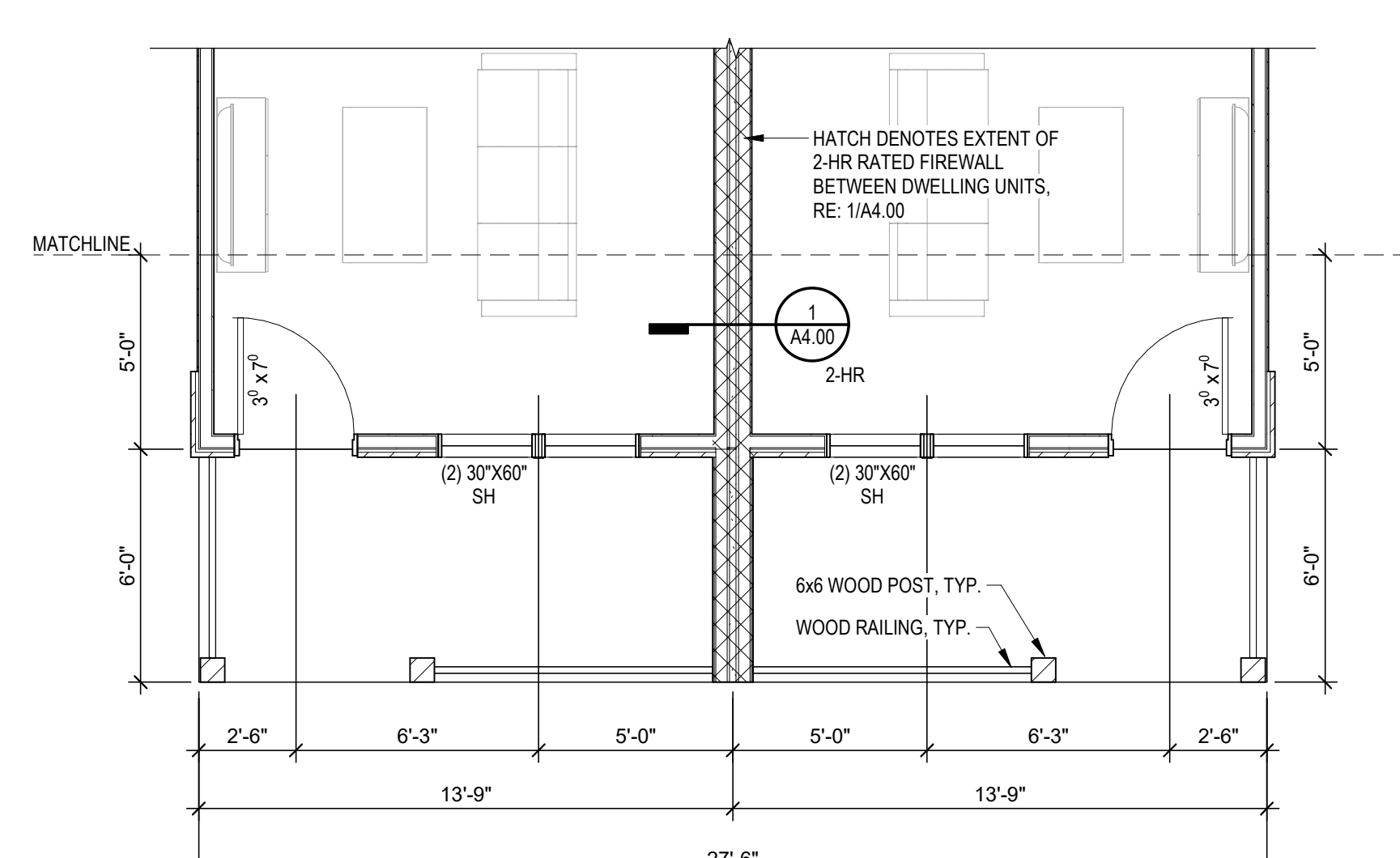

2 DOUBLE UNIT - OPTION 2
1/4" = 1'-0"

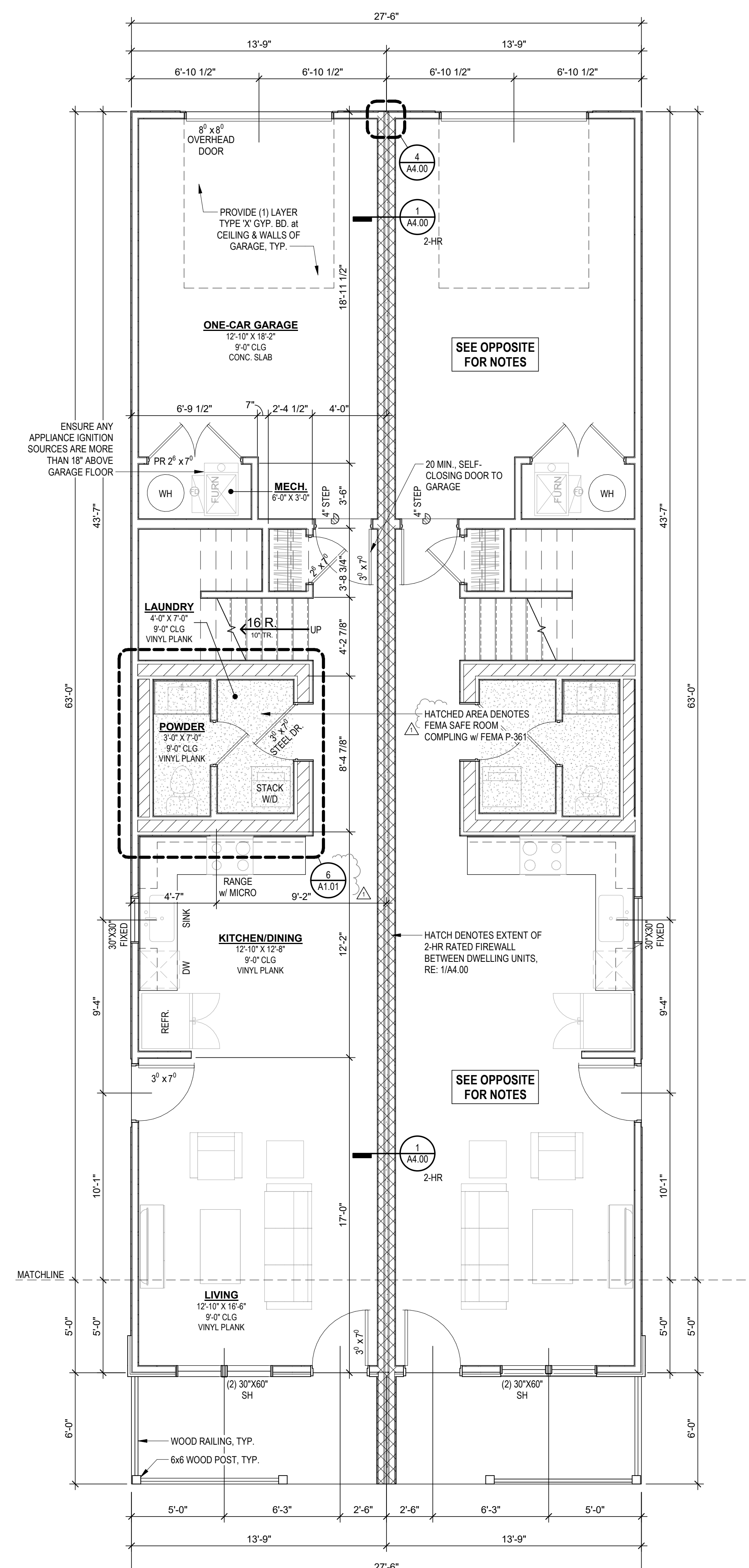

1 DOUBLE UNIT - OPTION 1
1/4" = 1'-0"